

RESIDENTIAL FOUNDATION HANDOUT*

Inverted "T" Foundation

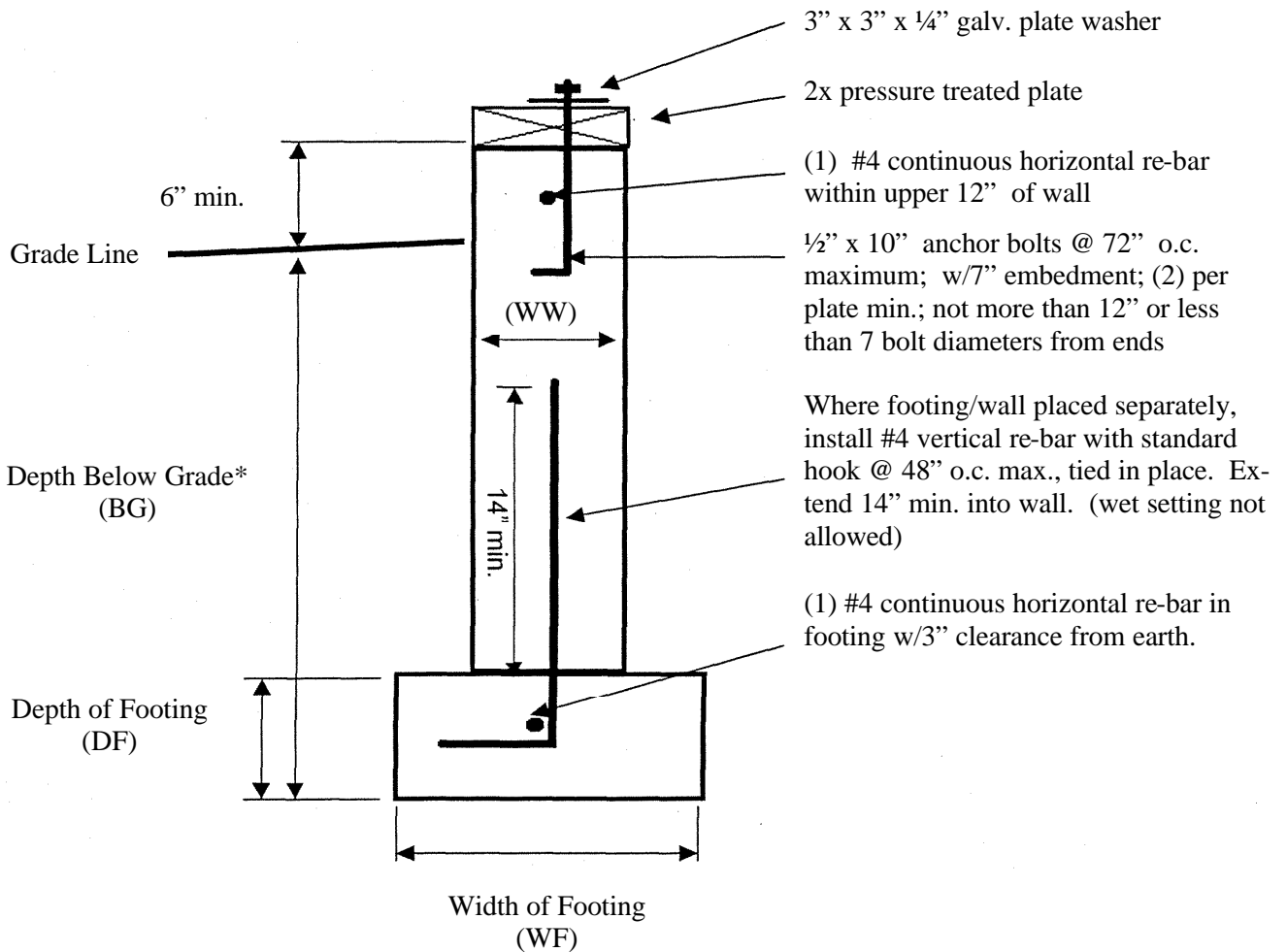

	WF	DF	BG*	WW
One Story	12"	6"	12"	6"
Two Story	15"	6"	12"	6"
Three Story	23"	8"	12"	8"

* Unbalanced Backfill not to exceed 48" in depth.

RESIDENTIAL FOUNDATION HANDOUT*

Monolithic Slab Foundation

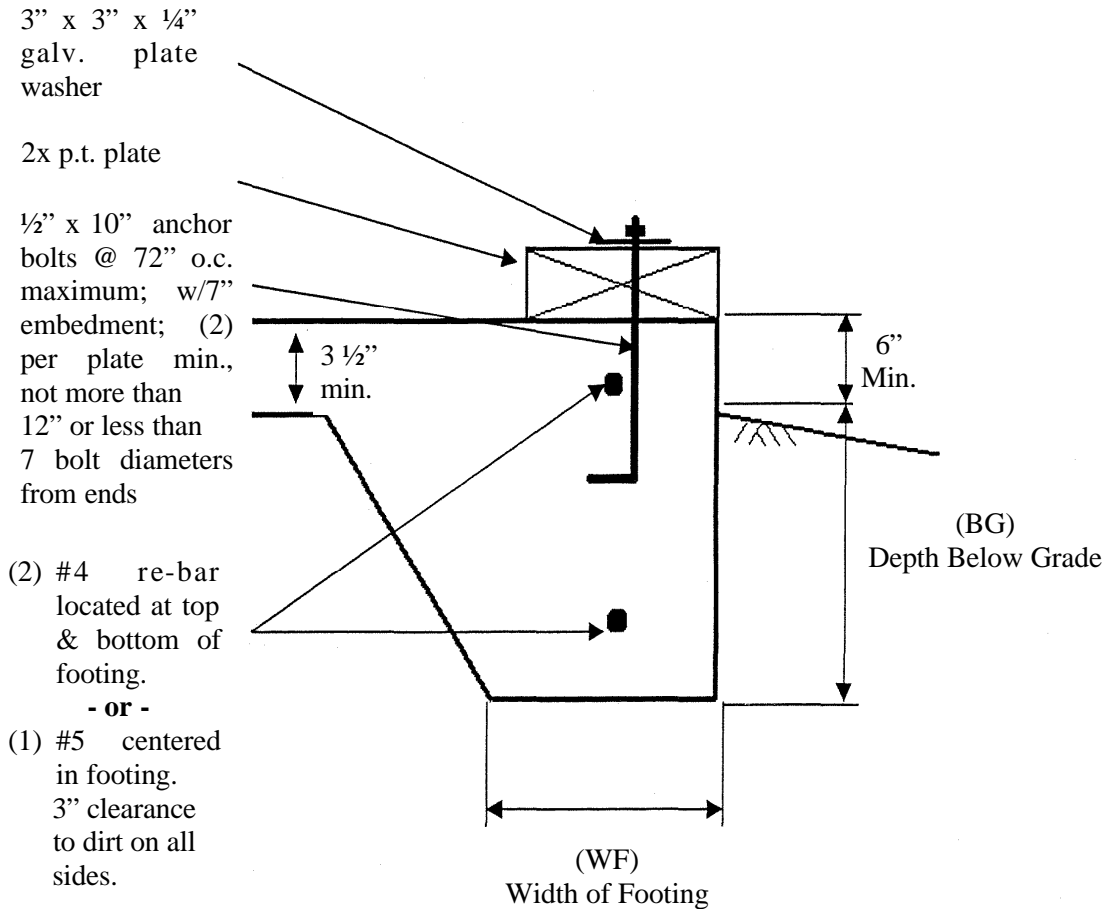

	WF	BG
One Story	12"	12"
Two Story	15"	12"
Three Story	23"	12"

www.co.grays-harbor.wa.us

**Grays Harbor County
Planning & Building Division**
Public Services Department
100 W Broadway Suite 31
Montesano, WA 98563
360-249-5579
360-249-3203 (fax)



pbd@co.grays-harbor.wa.us
www.co.grays-harbor.wa.us